



 wallace

Westfield Road, Hoddesdon, EN11 8QX |  
£685,000 | Freehold



## Westfield Road, Hoddesdon, EN11 8QX

Stunning four-bedroom detached property ideally situated in close proximity to Hoddesdon Town Centre. This exceptional home boasts an extensive driveway for parking multiple vehicles, as well as an oversized garage that presents an opportunity for conversion. The property also showcases an impeccably maintained 100ft south facing garden, featuring a manicured lawn, beautifully stocked flower and shrub beds, and an inviting garden pond. Internally, the house offers a modern and spacious four-piece family bathroom, ensuring comfort and convenience for the entire household. Additional highlights include a ground floor cloakroom, a charming garden room, and the potential for further extension. The property also benefits from a part-boarded loft, complete with a velux window and accessible via a drop down ladder. Upon entering the property, the traditional hallway leads to a large lounge/diner, which seamlessly flows into a bright garden room, offering a warm and inviting atmosphere. The kitchen is thoughtfully designed, featuring integrated appliances and generous space. The master bedroom boasts the added luxury of an en-suite. In conclusion, this delightful four-bedroom home presents a unique opportunity to own a stunning property within close proximity to Hoddesdon Town Centre. The abundance of features, from the attractive exterior and ample parking to the well-maintained garden and versatile living spaces, makes this a truly exceptional family home.

- Beautiful four bedroom detached home near Hoddesdon Town Centre

- Immaculate 100ft south facing garden with manicured lawn, flower beds, and pond.

- Ground floor cloakroom and charming garden room

- Large lounge/diner leading to a bright garden room.

- Ample driveway parking and oversized garage with conversion potential.

- Modern and spacious four-piece family bathroom

- Potential for further extension (stpp) and part-boarded loft with velux window.

- Well-planned kitchen with integrated appliances and generous space



 paulwallace  
estate agents

hoddesdon@paulwallace.co.uk

01992 466471











## Ground Floor

Approx. 92.9 sq. metres (999.6 sq. feet)

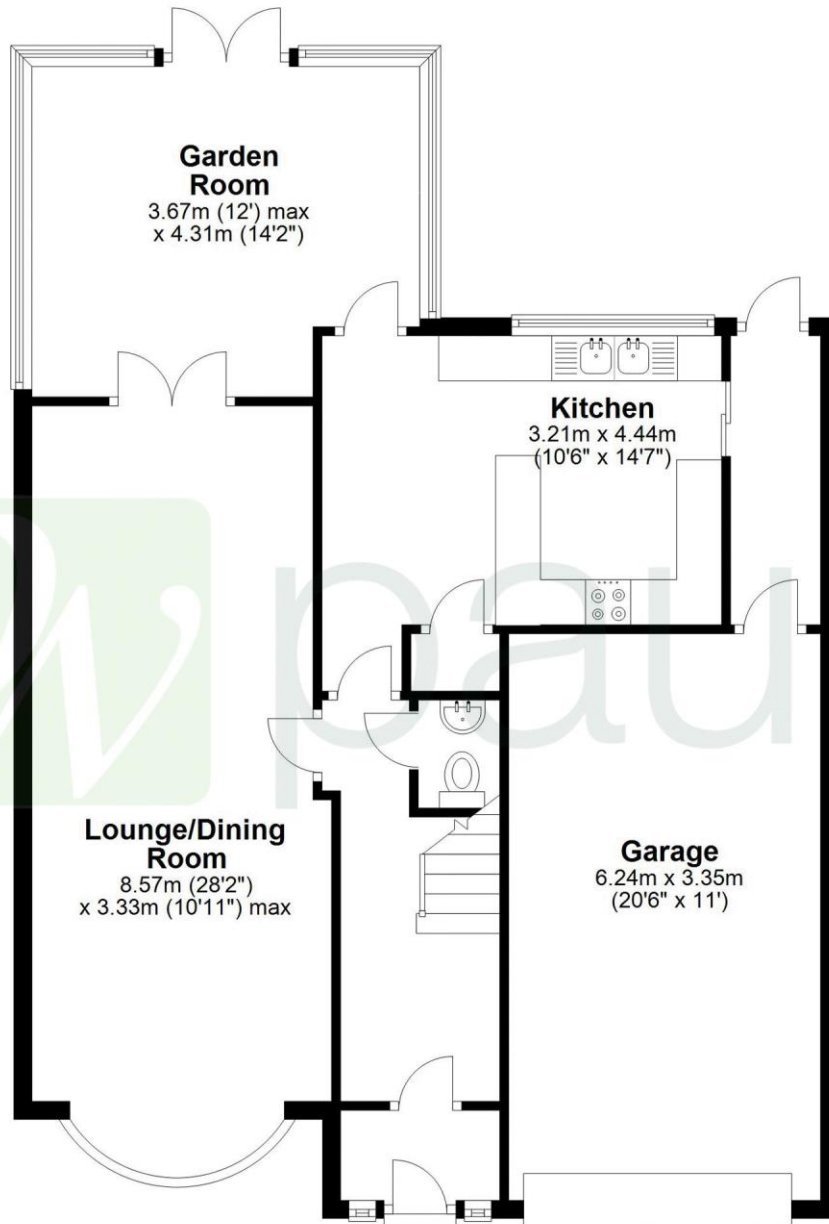

## First Floor

Approx. 71.3 sq. metres (767.1 sq. feet)

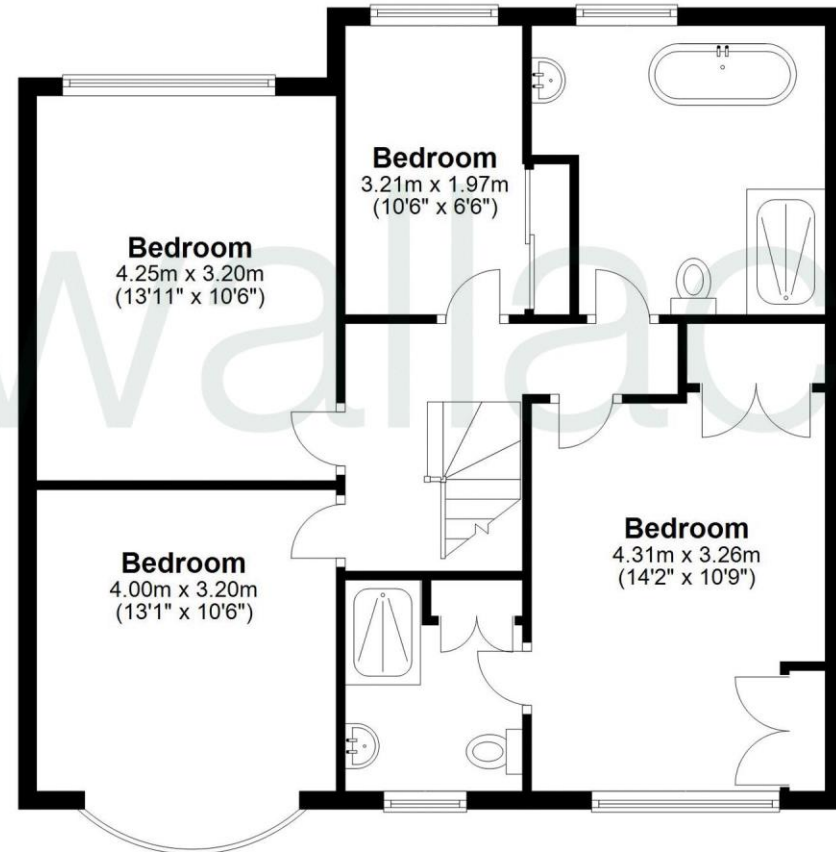

Total area: approx. 164.1 sq. metres (1766.7 sq. feet)

FOR ILLUSTRATIVE PURPOSES ONLY. NOT TO SCALE

Whilst every attempt has been made to ensure the accuracy of the floor plan shown, all measurements, positioning, fixtures, features, fittings and any other data shown are an approximate interpretation for illustrative purposes only and are not to scale. No responsibility is taken for any error, omission, miss-statement or use of data shown.

Property marketing provided by [www.matthewkyle.co.uk](http://www.matthewkyle.co.uk)



paulwallace



paulwallace



paulwallace



paulwallace









Registered Address: Unit 3 The Brookfield Centre, Cheshunt, Herts, EN8 0NN Company Registration Number: OC414280 | VAT Number: 276958046©2022 Paul Wallace Group LLP trading as Paul Wallace Estate Agents



### Paul Wallace Estate Agents

70 High Street  
Hoddesdon  
Hertfordshire  
EN11 8ET

 01992 466471

 [hoddesdon@paulwallace.co.uk](mailto:hoddesdon@paulwallace.co.uk)

 [www.paulwallace.co.uk](http://www.paulwallace.co.uk)



### Opening Times

Mon	9am to 6.30pm
Tues	9am to 6.30pm
Wed	9am to 6.30pm
Thurs	9am to 6.30pm
Fri	9am to 6.30pm
Sat	9am to 5.00pm
Sun	Closed



Agents Note: Whilst every care has been taken to prepare these sales particulars, they are for guidance purposes only. All measurements are approximate and are for general guidance purposes only and whilst every care has been taken to ensure their accuracy, they should not be relied upon. Potential buyers are advised to recheck the measurements.